

# RETUNING YOUR HOMECAST RECEIVER

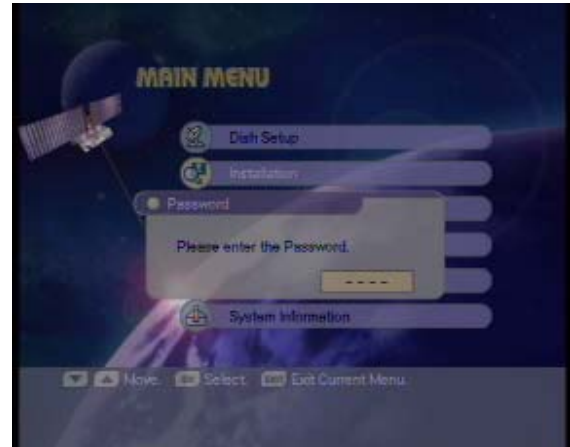

**STEP 1**  
On the Homecast Remote press "Menu" button. Using the lower arrow on the Remote Control go to Installation and press "OK"



**STEP 2**  
Window opens for password input 0 0 0 0  
Using the number pad on the Remote enter



**STEP 3**  
The installation Menu opens up. Go down to "Scan Transponder" and press "OK"



**STEP 4**  
Go down to frequency and using left arrow key blank the numbers



**STEP 5**  
In the Frequency enter the number 1 2 7 0 6



**STEP 6**  
Go down to Symbol rate and blank the numbers using left arrow key



**STEP 7**  
In the Symbol Rate enter 2 2 5 0 0



**STEP 8**  
Go down to Polarity and change it to "Vertical"



**STEP 9**  
Go down to Code rate and change it to 3 /4 by using left or right arrow key



**STEP 10**  
Go down to Network Search and change it to Enable and Scan using the remote control

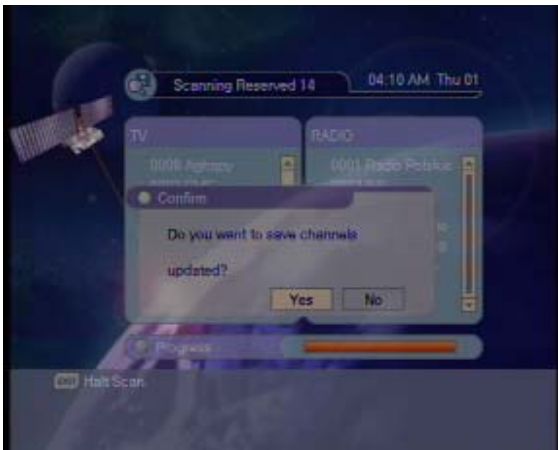

**STEP 11**  
The receiver will scan for channels on this frequency. Press "OK" to save this new list of channels. Scroll through the channels to go to favourite channel.

Scroll to your favourite channel (Using Remote control do channel up). Please note after the scanning the STU may store previous list of channels in their current channel position and the new channel list added to it. Please scroll through all channels